



Instruction Manual  
COFFEE GRINDER

# COFFEE GRINDER



CG 8011

# COFFEE GRINDER

## CONTENT

- 3 Catler recommends safety first
- 10 Know your CG 8011 coffee grinder
- 12 Key elements of your CG 8011 coffee grinder
- 13 Operating your CG 8011 coffee grinder
- 16 Care and Cleaning



# Congratulations

on the purchase of your new CG 8011 coffee grinder.

## CATLER RECOMMENDS SAFETY FIRST

We understand the importance of safety and that's why we put your safety first from the initial design concept to the production itself. Nevertheless, please be careful and follow the instructions below when using this appliance.

- This appliance is not to be used by children. Keep this appliance and its power cord out of children.
- The appliances may be used by persons with physical or mental impairments or by inexperienced persons only if they are properly supervised or have been informed about how to use of the product in a safe manner and understand the potential dangers.
- Children must not play with the appliance.
- Cleaning and maintenance performed by the user must not be performed by children.
- If the power cord is damaged, ask the authorised service for a replacement in order to prevent hazards. It is forbidden to use the appliance if it has a damaged power cord.
- Always disconnect the appliance from the power socket if you are leaving it unattended and before assembly, disassembly or cleaning.
- Before exchanging the accessories or accessible movable parts, please turn the appliance off

and disconnect it from the power supply.

- Please pay increased attention to handling the millstones. Incorrect use may lead to injury.
- The coffee bean hopper as well as the ground coffee container can be washed in warm water with a small amount of washing-up liquid. Rinse and wipe dry.
- This appliance is designed for household use only. This appliance is not designed for commercial use. Do not use this appliance in moving vehicles or on boats, outdoors, or for any purpose other than it's intended. Otherwise, there is a risk of personal injury.
- The appliance is not intended for use in premises such as:
  - staff kitchens in stores, offices and other workplaces;
  - hotel or motel rooms and other living areas;
  - agricultural farms;
  - bed and breakfast establishments.
- Do not submerge the appliance, power cord or plug in water or any other liquid.
- Make sure that the mains cord and plug does not come into contact with water or other fluid.

- Use the appliances according to the instructions in this user's manual. Otherwise injury, damage to the appliance or dangerous situation might occur.
- Do not use this appliance with a programmable switch, timer switch or any other device that automatically switches the appliance on.
- This appliance has been designed ONLY to grind roasted coffee beans. Never use the appliance for purposes other than those for which it was designed.
- This appliance is NOT designed to grind pre-ground coffee. Under no circumstances should the appliance be used to grind gluey food or extremely hard food, to make dough and grind fruit, seeds or herbs for example to produce curry pasta or nut butter.
- Do not put metallic objects or similar items that might damage or adversely influence the appliance operation in the coffee bean hopper.
- Before connecting the appliance to a power socket, check that the nominal voltage on the appliance's rating label matches the electrical voltage in the socket.

- Connect the appliance only to a properly grounded socket. For safety reasons, we don't recommend using adaptor plugs or extension cords.
- Do not place the appliance on windowsills, sink drip tray or on unstable surfaces. Always place the appliance on an stable, flat and dry surface.
- Do not place the appliance on electric or gas cooker or in the vicinity of naked flame.
- Never use the appliance in close vicinity of a bath, shower or swimming pool.
- Only use the appliance with the original supplied accessories.
- Always turn the appliance off and disconnect from the power socket if it's to be unused or left unattended, before disassembling or assembling, before filling the hopper or before moving or cleaning. Allow the appliance to fully cool down before cleaning or moving.
- Keep the appliance and its accessories in clean condition.
- Perform the cleaning and maintenance in accordance with the instructions in chapter Cleaning and maintenance. Never wash the



appliance under running water or submerge it in water or another liquid.

- Before turning the appliance on, attach the coffee bean hopper lid properly on the hopper.
- Do not turn the appliance on until the coffee bean hopper and the lid is properly secured in place.
- Do not use the appliance if the coffee bean hopper is not properly attached. Be careful during operation and do not insert fingers, hands, hair, clothing or kitchen utensils in the vicinity of the coffee bean hopper.
- Do not use the appliance for longer than 2 minutes, otherwise it might overheat. If such situation occurs, please turn the appliance off and disconnect it from the power supply. Allow the appliance to cool down for 20 minutes, then try to turn it on again.
- Before connecting this appliance to a power socket, make sure the voltage stated on the product's rating label corresponds to the voltage in your power socket.
- Do not disconnect the appliance from the power socket by pulling the power cord. This could damage the power cord or the power

socket. Disconnect the cord from the power socket by gently pulling the plug of the power cord.

## **IMPORTANT SAFETY INSTRUCTIONS FOR USING ELECTRICAL EQUIPMENT**

- Fully unwind the power cord before use.
- Do not leave the power cord hanging over the edge of a table or countertop or allow it to touch a hot surface or to become tangled up. Do not put heavy objects on the power cord.
- For safety reasons, we recommend to connect the appliance in an independent electrical circuit separated from other appliances. Do not use adapter plugs or extension cords to connect the appliance to a power outlet.
- To prevent potential electric shock, do not submerge this appliance, its base or power cord in water or any other liquid.
- We recommend that you inspect the appliance regularly. Do not use the appliance if it is damaged in any way or if the power cord or plug are defective. All repairs or adjustments must be performed at the nearest Catler authorised service centre.

- Any maintenance other than standard cleaning must be performed at authorised Catler service centre.
- We recommend to install a residual current device (standard safety switches in your power outlet) to provide a higher level of protection when using the appliance. We recommend to install a residual current device (with a nominal residual operating current of no more than 30mA) in the electric circuit in which your appliance is to be connected. For further expert advise, please contact your electrician.

# KNOW YOUR CG 8011 COFFEE GRINDER

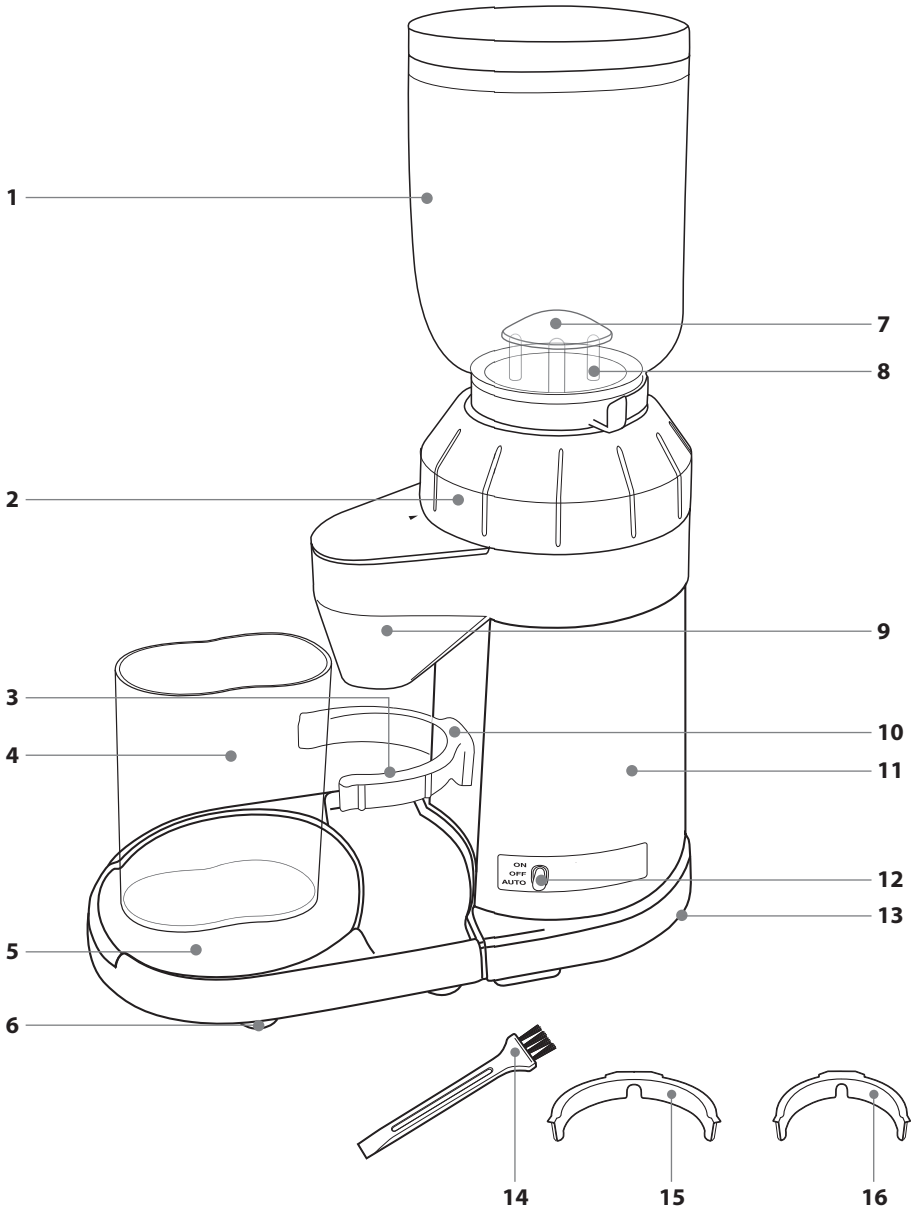

1. **Coffee bean hopper**

The coffee bean hopper with a capacity of 250g is equipped with a special lockable system to facilitate handling the hopper and transferring unused coffee beans into the air-tight container.

2. **Control knob to set the milling fineness**

The control knob's rotary mechanism allows you to select the correct milling level from 40 presets. You can easily and comfortably grind your coffee for various uses from French press to espresso machines.

3. **Handle holder**

The coffee grinder is supplied with two holders of different sizes. Thus, you can grind your coffee directly into the holder for both professional and household coffee machine.

4. **Ground coffee jar**

5. **Detachable base**

Captures excess coffee during grinding.

6. **Antiskid feet**

Anti-skid rubber feet ensure the grinder's stability and prevent it from undesired movement during operation.

7. **Grinder cover**

8. **Conic grinder**

Your stainless-steel conic grinder is designed to reach great results at all times. Thanks to the slow torque, the millstones can reduce the friction while grinding the coffee beans, thus preventing the millstones from excessive heating during grinding, which avoids the deterioration of ground coffee and the resulting coffee drink.

9. **Ground coffee release chamber**

The release chamber is designed to allow you to grind coffee directly into the handle as well as the jar.

10. **Automatic grinding switch**

Insert the handle with the strainer fitted into the holder. Press the handle grip towards the grinder to enable the automatic grinding switch. When there is enough ground coffee in the strainer, press the handle grip again to stop the grinding.

11. **Stainless grinder housing**

The stainless grinder housing with a built-in motor forms a stable and powerful grinder base.

12. **Start/stop trigger**

Set the main switch to one of the following positions as needed:

ON position - designed for continuous grinding into the jar.

OFF position - designed to stop or pause the operation.

AUTO position - designed mainly for grinding directly into the handle, the grinding being enabled by the automatic grinding switch.

13. **Power cord storage space**

There is a holder at the grinder bottom to store the power cord.

## ACCESSORIES

14. **Cleaning brush**

15. **58mm handle switch**

16. **52mm handle switch**

17. **Protective caps** (not shown)

Allow you to easily grind directly into the handle strainer and prevent the ground coffee from falling from the strainer.

## KEY ELEMENTS OF YOUR CG 8011 COFFER GRINDER

### Maintenance-free design

The innovative design makes the coffee grinding very easy. Thus, you will be able to enjoy true espresso coffee from freshly ground beans without having to clean your grinder in a complex manner.

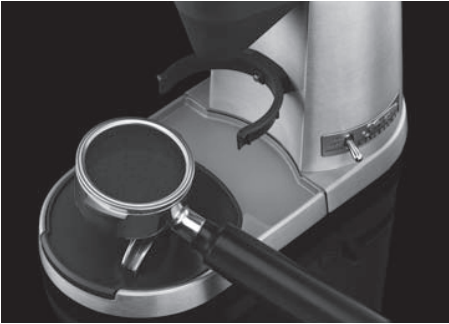

### Great detachable base

A great detachable base captures the ground coffee residues during grinding. You can easily remove and clean it. The base is equipped with a silicone pad for you to put the handle on easily and beat the ground coffee in the strainer.

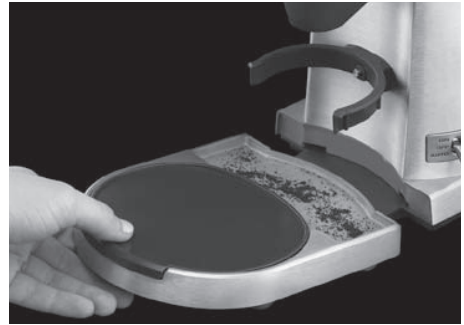

### Slow grinding

A combination of a powerful gear motor with a conic grinder guarantees a slow grinder run. Thanks to the slow torque, the millstones can reduce the friction while grinding the coffee beans, thus preventing the millstones from excessive heating during grinding, which avoids the deterioration of ground coffee and the resulting coffee drink.

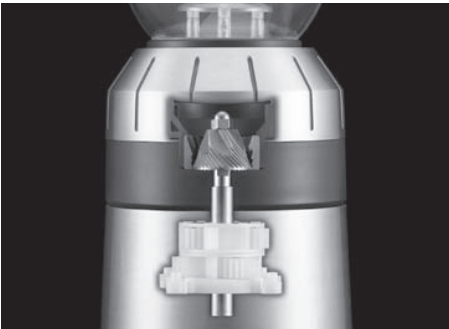

### Automatic grinding switch

The automatic grinding switch will allow you to grind your coffee directly into the handle strainer. This will give you absolute control over the ground coffee amount as you can toggle the switch on and off with just one push. Thus, you can stop the grinding process at the right moment.



## OPERATING YOUR CG 8011 COFFER GRINDER

### BEFORE FIRST USE

Remove all packaging from the appliance and dispose of it in a proper manner. Before a proper disposal, make sure you have removed all accessories from the packaging. Wash the accessories in warm water with a small amount of washing-up liquid, rinse thoroughly under running water and wipe dry.

Wipe the grinder with a soft sponge lightly moistened in warm water and wipe dry.

### BASIC OPERATION

1. Put the appliance on a flat, dry and clean surface.
2. Insert the empty coffee bean hopper on the grinder base and turn the hopper anticlockwise - see figure below.

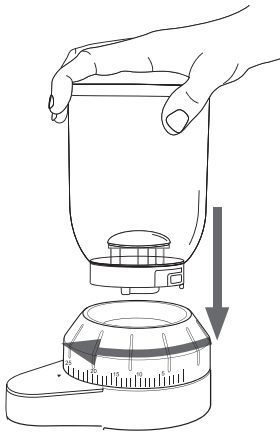

3. Pour coffee beans into the hopper.

### NOTE

We recommend to fill the hopper up to the maximum level line. This will exert a constant pressure on the millstones which is important for correct grinding.

### WARNING!

**Please put only fresh roasted coffee beans in the coffee bean hopper. Never put ground coffee, crushed coffee beans, nuts or other foods in the hopper.**

4. Attach the lid on the hopper.
5. Insert the mains cord plug into a power socket.
6. Using the control knob, set the desired milling fineness - see figure below. It's important to select the milling fineness according to the coffee making method. For detailed information on the milling fineness, please refer to further sections of this manual.

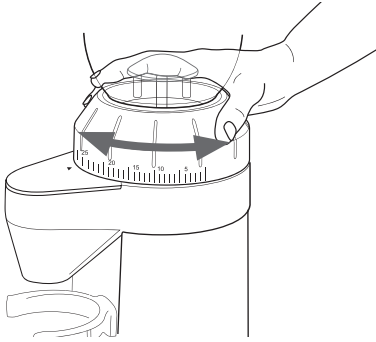

7. Depending on the used accessories, you can grind into the jar or directly into the handle strainer.

a) Grinding into the jar

- Remove the jar lid and put the jar under the ground coffee release point - see figure below.

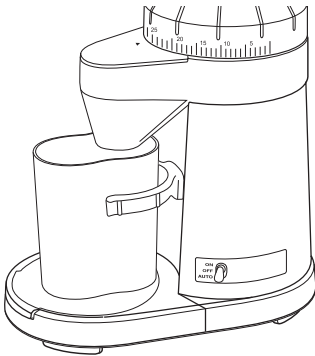

- Set the main switch to the ON position. The grinder will start with the ground coffee falling into the jar.
- When the grinder has ground sufficient amount of coffee, set the main switch to the OFF position. Remove the jar and wipe off the excess ground coffee.

b) Grinding into the handle strainer

- According to the used handle size, insert either 58mm or 52mm holder under the release point. Inert the handle in the holder - see figure below.

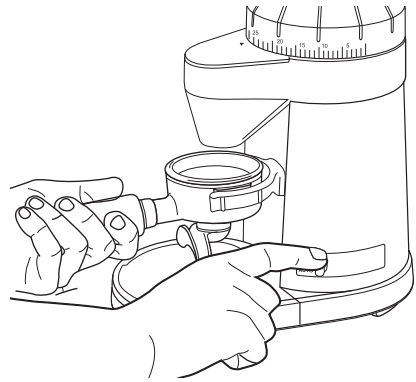

- Set the main switch to the AUTO position.
- Press the handle grip towards the grinder to enable the automatic grinding switch - see figure below.

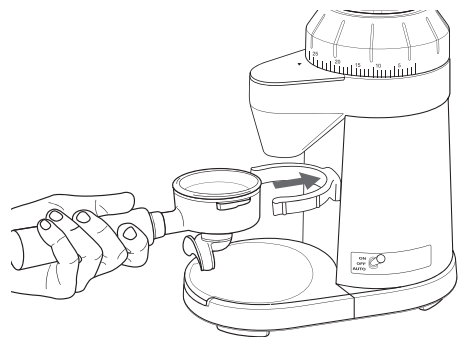

- When there is enough ground coffee in the strainer, press the handle grip again to stop the grinding.



#### NOTE

To ensure the stability of the jar or the handle, we recommend you to use the supplied holders to insert the jar or the handle.

### CONTROLLING THE MILLING FINENESS

Your grinder allows you to grind coffee for different coffee making methods. It's equipped with 25 milling fineness presets.

#### MILLING FINENESS TABLE

Controlling the milling fineness	Coffee making method
FINE-5	Brewed coffee
5-10	Espresso coffee machines
10-15	Making coffee in moka pots
15-20	Drip coffeemakers
20-COARSE	Making coffee in a French press

When selecting the milling fineness, please note the following:

- The finer the ground coffee is, the longer the water runs through the strainer.
- The finer the ground coffee is, the higher is the risk of choking the grinder and the release point. In such case, you can slightly tap the hopper lid during grinding to release the blocked ground coffee.
- If you ground very fine coffee for a prolonged period of time, we recommend that you clean the millstones after some time. The cleaning procedure is described in the Care and Cleaning chapter further in this manual.

### TIPS AND TRICKS

Always select the fineness setting level according to the coffee making method - see the fineness setting table in the previous manual sections.

When making drip coffee, about 8g of ground coffee comes out to 4 cups, however, setting the grinding fineness to a too fine level may cause the coffee to be too bitter. If you prefer coffee with weaker taste, make the coffee as recommended, then pour some hot water in the cup.

If the ground coffee used is excessively fine, the coffee extraction may be very slow. The resulting coffee will be very over-extracted and very bitter. On the other hand, too coarsely ground coffee will speed up the extraction with the resulting coffee being under-extracted, slack and without strong taste.

The ground coffee will lose its taste and flavour very quickly. We recommend that you always use freshly ground coffee when making coffee.

Buy coffee beans in smaller packages with the roasting date stated.

To prolong the coffee bean freshness, store the coffee beans in an air-tight container in a cool, dark and dry place. The coffee bean hopper is not suitable for storing coffee beans. Thus, it's important for you to transfer the coffee beans from the hopper to an appropriate container for storage.

Keep the grinder in a clean condition. This will ensure that you always reach the best results when making coffee.

## CARE AND CLEANING

Before cleaning, set the main switch to the OFF position, unplug the mains cord from the power outlet and allow the appliance to cool down properly.

**WARNING!**  
To prevent electric shock, do not submerge this appliance, plug or power cord or in water or any other liquid. No part of your appliance is suitable for dishwasher use.

**WARNING!**  
Do not use abrasive cleaning agents, steel wools, wire sponges etc., as these might damage the surface.

### **CLEANING THE GRINDER BASE, COFFEE BEAN HOPPER AND GROUND COFFEE JAR**

1. Remove the coffee bean hopper from the grinder base and transfer the unused coffee beans in an air-tight container.
2. Wipe the grinder base with a soft sponge lightly moistened in warm water and wipe dry.
3. Wash the coffee bean hopper, ground coffee jar and lid in warm water with a small amount of washing-up liquid, rinse thoroughly under running water and wipe dry.

### **CLEANING THE MILLSTONES**

Depending on the grinder frequency of use, the millstones should be cleaned on regular basis. If you use the grinder daily, it's necessary to clean the millstones about every three weeks to ensure correct grinder operation. Regular maintenance will extend the lifetime of the millstones, therefore the lifetime of the entire grinder.

1. Make sure the grinder is turned off, the mains cord is unplugged from the power socket and the grinder is cool.
2. To remove the upper millstone, turn the fineness control knob anticlockwise until it stops - see figure below.

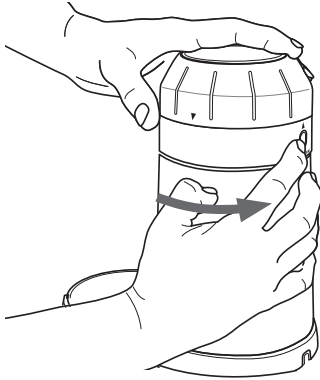

3. Press and hold the UNLOCK button at the back of the grinder base. Turn the milling fineness control knob anticlockwise with your other hand until the graphic mark on the milling fineness control is aligned with the one on the grinder base. This upper millstone can be only removed in this way - see figure below.

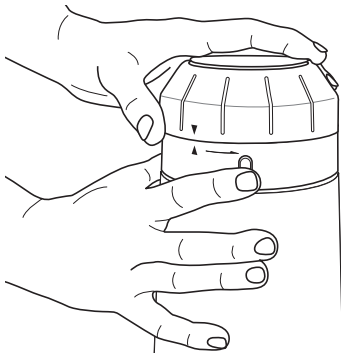

4. Keep the UNLOCK button pressed and lift the upper millstone by the grip with your other hand to remove it - see picture below. Release the button.

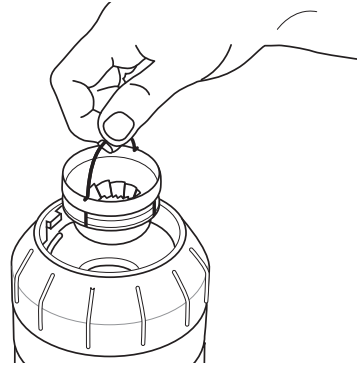

5. Clean the upper millstone with the supplied cleaning brush.
6. In order to clean the lower millstone, lift the fineness control knob slowly - see figure below.

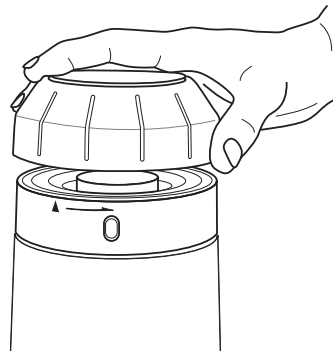

7. Clean the lower millstone using the supplied cleaning brush.
8. When the millstones are clean, attach the fineness control knob back on the grinder base. The graphic mark on the control must be aligned with the one on the grinder base.

9. Put the upper millstone back and turn the fineness control knob clockwise, until the graphic mark on the control is aligned with the coarsest grinding mark and the UNLOCK button pops up. Check the placement of the upper millstone and lower its handle.

## **STORAGE**

If the grinder is to be left unused, clean it according to the above instructions. Store the grinder in a well-ventilated dry place out of reach of children and animals.

## INSTRUCTIONS AND INFORMATION REGARDING THE DISPOSAL OF USED PACKAGING MATERIALS

Dispose of packaging material at a public waste disposal site.

### DISPOSAL OF USED ELECTRICAL AND ELECTRONIC APPLIANCES



The meaning of the symbol on the product, its accessory or packaging indicates that this product shall not be treated as household waste. Please, dispose of this product at your applicable collection point for the recycling of electrical & electronic equipment waste. Alternatively in some states of the European Union or other European states you may return your products to your local retailer when buying an equivalent new product. The correct disposal of this product will help save valuable natural resources and help in preventing the potential negative impact on the environment and human health, which could be caused as a result of improper liquidation of waste. Please ask your local authorities or the nearest waste collection centre for further details. The improper disposal of this type of waste may fall subject to national regulations for fines.

#### **For business entities in the European Union**

If you wish to dispose of an electrical or electronic device, request the necessary information from your seller or supplier.

#### **Disposal in other countries outside the European Union**

If you wish to dispose of this product, request the necessary information about the correct disposal method from local government departments or from your seller.



This product meets all the basic EU regulation requirements that relate to it.

Changes to the text, design and technical specifications may occur without prior notice and we reserve the right to make these changes.

The original version is in the Czech language.

Address of the manufacturer: FAST ČR, a.s., U Sanitasu 1621, Říčany CZ-251 01

Because of continuous improvement of design and other properties, your product may slightly differ from the one shown on the pictures in this manual.

Z důvodu neustálého zdokonaľování designu a dalších vlastností se může vámi zakoupený výrobek mírně lišit od výrobku uvedeného na obrázcích v tomto návodu.

Z dôvodu neustáleho zdokonaľovania dizajnu a ďalších vlastností sa môže vami kúpený výrobok mierne líšiť od výrobku uvedeného na obrázkoch v tomto návode.

A kivitel és más jellemzők állandó fejlesztése miatt a megvásárolt termék enyhén eltérhet az ezen útmutatóban található képeken mutatott terméktől.

Ze względu na ciągle udoskonalanie designu i innych właściwości, zakupiony produkt może się nieznacznie różnić od produktu przedstawionego na rysunkach w niniejszej instrukcji.

Из-за постоянного улучшения дизайна и других свойств ваш продукт может немного отличаться от представленного на рисунках в данном руководстве.



**WWW.CATLER.EU**