



Instructions for use
FOOD GRINDER FOOD+

FOOD GRINDER FOOD+



FG 403

**FOOD
GRINDER
FOOD+**

TABLE OF CONTENTS

5	Catler recommends safety first
9	Know Your FG 403 FOOD+
14	Assembling Your FG 403 FOOD+
16	Operating your FG 403 FOOD+
18	Care and Cleaning
19	Troubleshooting



Congratulations

on the purchase of your new FG 403 Food Grinder FOOD+.

CATLER RECOMMENDS SAFETY FIRST

We understand the importance of safety and that's why we put your safety first from the initial design concept to the production itself. Nevertheless, we ask you to be careful when using electrical equipment and to observe the following guidelines:

- This appliance is not to be used by children. Keep this appliance and its power cord out of children.
- The appliances may be used by persons with physical, sensory or mental impairments or by inexperienced persons only if they are properly supervised or have been informed about how to use of the product in a safe manner and understand the potential dangers.
- Children must not play with the appliance.
- Cleaning and maintenance performed by the user must not be performed by children.
- If the power cord is damaged, ask the authorised service for a replacement in order to prevent hazards. It is forbidden to use the appliance with the power cord damaged.

WARNING: Improper use can cause injury.

- Be careful when handling the juicing screw, especially when inserting or removing it, and during cleaning.

- Do not use the appliance if the rotary strainer is damaged.
- Be careful when handling the grinding blade, especially when inserting or removing it, and during cleaning. Grinding blades are sharp and there is a risk of serious injury.
- Be careful when handling the graters, especially when inserting or removing them from the neck, and during cleaning.
- Clean the parts of the appliance and accessories that come into contact with food according to the instructions in this manual.
- Always disconnect the appliance from the power socket if you are leaving it unattended and before assembly, disassembly or cleaning.
- Before replacing the accessories or accessible movable parts, please turn the appliance off and disconnect it from the power supply. Always wait until the accessories or rotating parts have come to a complete stop.
- Use the appliance only with the accessories supplied with it. The use of other accessories is prohibited.
- Use the appliance according to the instructions in this manual. Otherwise, there is a risk of personal injury.

- This appliance is designed for home use only. This appliance is not designed for commercial use. Do not use this appliance in moving vehicles or on boats, outdoors, or for any purpose other than it's intended. Otherwise, there is a risk of personal injury.
- Before connecting this appliance to a power socket, make sure the voltage stated on the product's rating label corresponds to the voltage in your power socket.
- Place the appliance on a stable, heat-resistant, flat and dry surface away from the edge of the worktop.
- Do not place the appliance on or near heat sources such as hotplates, ovens or gas burners. Vibrations during operation may cause the appliance to move.
- Do not use this appliance with a programmable switch, timer switch or any other device that automatically switches the appliance on.
- Before switching on the appliance, make sure it is correctly assembled.
- Do not attempt to grind bones, nutshells or other hard ingredients.
- Do not leave the appliance running continuously under heavy load for more than 5 minutes. Before turning it on again, allow it to cool down for at least 10 minutes.
- Never use your fingers or other objects to push ingredients through the filling funnel. Always use the provided plunger.
- If the ingredients inside the grinding chamber become clogged, use the reverse button to remove the clogged ingredients.
- Never run the appliance without liquid. This may damage the lid.
- Always switch off the appliance and disconnect it from the power supply when you have finished processing ingredients.
- To prevent electric shock, do not immerse the appliance, the power cord or the power cord plug in water or other liquid.
- Check the condition of the appliance regularly. Never use a damaged appliance or an appliance with a damaged accessory, power cord or plug.
- Do not disconnect the appliance from the power socket by pulling on the power cord. This could damage the power cord or the power socket. Disconnect the cord from the power socket by gently pulling the plug of the power cord.

IMPORTANT SAFETY INSTRUCTIONS FOR USING ELECTRICAL EQUIPMENT

- Fully unwind the power cord before use.
- Do not leave the power cord hanging over the edge of a table or countertop or allow it to touch a hot surface or to become tangled up. Do not put heavy objects on the power cord.
- For safety reasons, we recommend to connect the appliance in an independent electrical circuit separated from other appliances. Do not use adapter plugs or extension cords to connect the appliance to a power outlet.
- To prevent electric shock, do not immerse the appliance, its base or the power cord in water or other liquids.
- We recommend that you check your appliance regularly. Do not use the appliance if it is damaged in any way or if the power cord or plug is defective. All repairs or adjustments must be performed at the nearest Catler authorised service centre.
- Any maintenance other than routine cleaning must be entrusted to an authorised Catler service centre.

- We recommend to install a residual current device (standard safety switches in your power outlet) to provide a higher level of protection when using the appliance. We recommend to install a residual current device (with a nominal residual operating current of no more than 30mA) in the electric circuit in which your appliance is to be connected. For further expert advice, please contact your electrician.

Instructions are also available at www.catler.eu.

KNOW YOUR FG 403 FOOD+

MOTOR UNIT

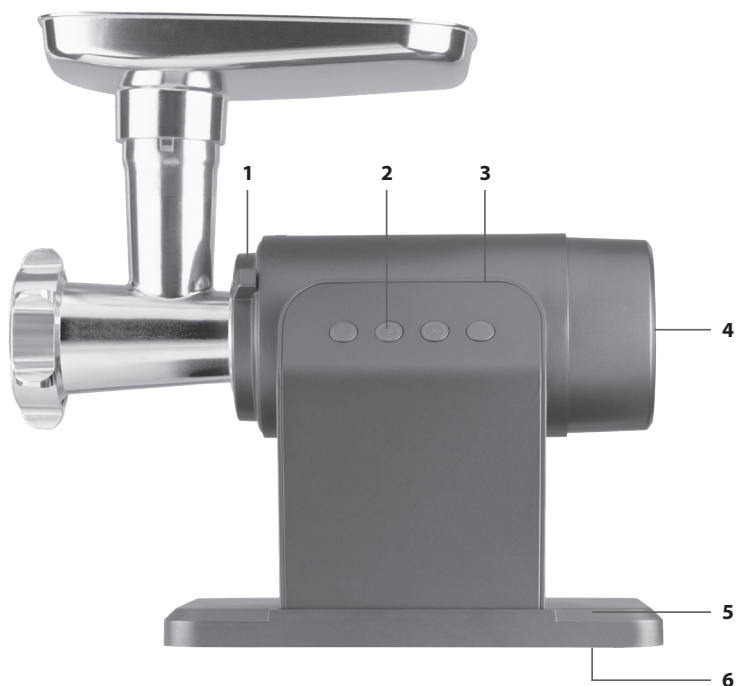

1. Safety lock
2. Control panel
3. Motor Unit
4. Ventilation openings
5. Base
6. Suction cups (located at the bottom, provide greater stability of the base)

CONTROL PANEL

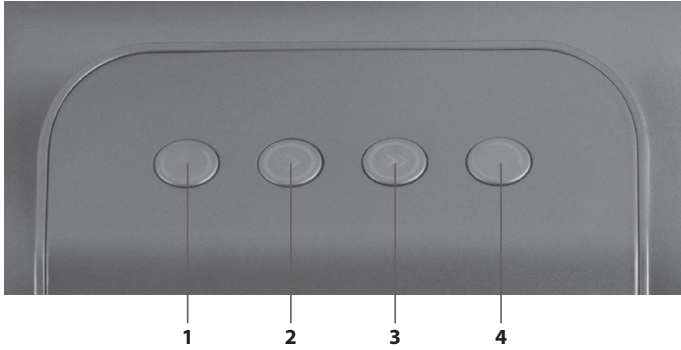

1.  button: used to switch the appliance on/off
2. Low speed button
3. High speed button
4. Reverse button

DESCRIPTION OF ACCESSORIES

Juicing Attachment

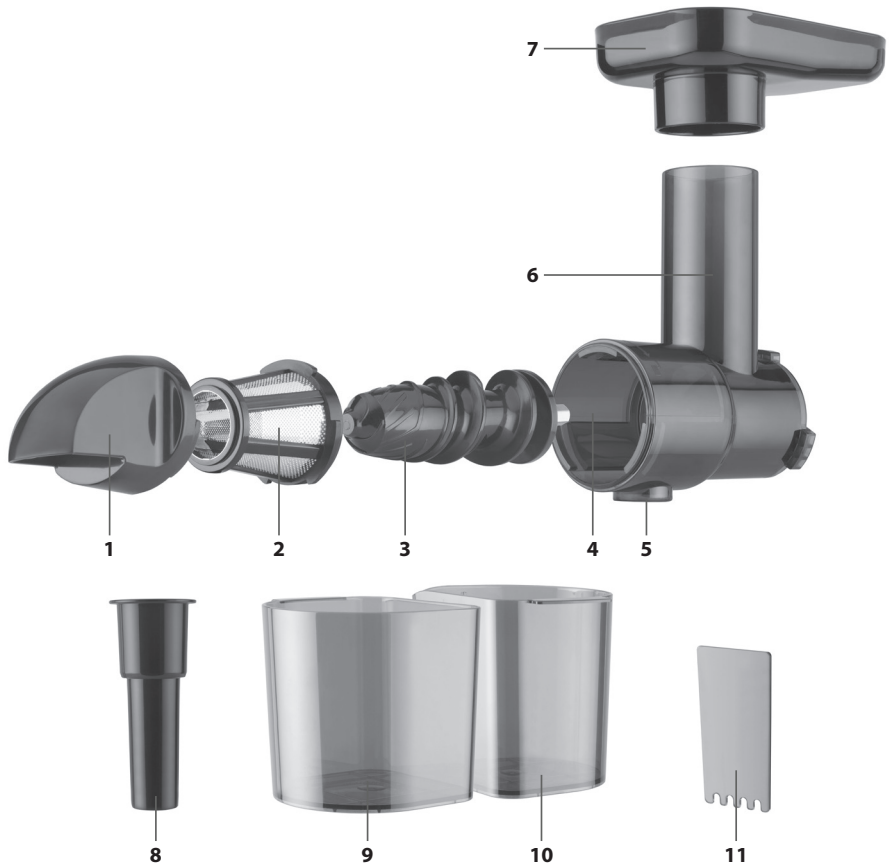

1. Front cover with pulp outlet
2. Fine strainer
3. Worm shaft for juicing
4. Grinding chamber
5. Juice outlet
6. Filling funnel
7. Juicing attachment hopper
8. Juicing attachment plunger
9. Pulp container
10. Juice jug
11. Pulp separator

Food Grinder

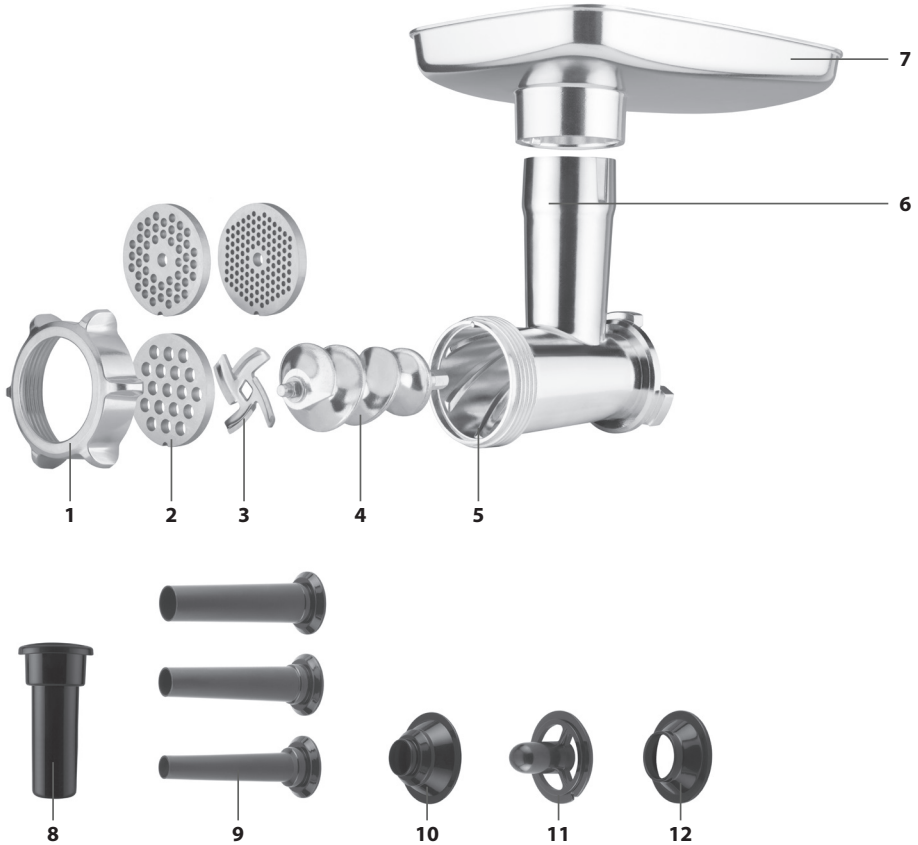

1. Screw ring
2. Grinding discs
3. Grinding blade
4. Food grinder worm shaft
5. Grinding chamber
6. Filling funnel
7. Food grinder hopper
8. Food grinder plunger
9. Attachments for sausage preparation
10. Cover for sausage preparation attachment
11. Attachment for kubbe preparation
12. Cover for kubbe preparation attachment

Cutting and grating attachment

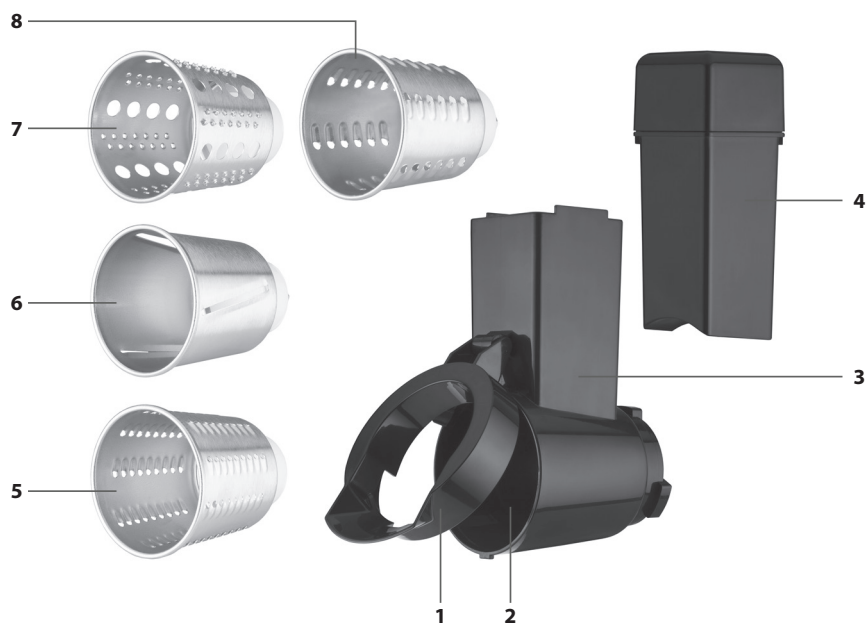

1. Grater lock
2. Grinding chamber
3. Filling funnel
4. Pusher
5. Fine grater
6. Slicer
7. Puree grater
8. Coarse grater

ASSEMBLING YOUR FG 403 FOOD+

ASSEMBLING THE JUICING ATTACHMENT

1. Place the motor unit on a dry, level and firm surface.
 2. Make sure that the lock is turned so that the arrow points to the open lock symbol.
 3. Insert the juicing attachment into the motor unit so that the protrusions on the attachment fit into the cut-outs in the fixing thread. Then turn the lock clockwise until the arrow points to the closed lock symbol and you feel resistance.
 4. Insert the juicing worm shaft into the juicing attachment. Rotate the worm shaft as necessary to engage the bearing in the motor unit.
 5. Insert the fine strainer into the juicing attachment so that the protrusions on the strainer fit into the cut-outs in the attachment. Push the strainer slightly to make sure it is inserted correctly and not loose.
 6. Fit the front cover onto the juicing attachment so that the protrusions on the cover fit into the cut-outs in the attachment. Then turn the cover counterclockwise until you reach the closed lock symbol and feel resistance.
 7. Fit the hopper onto the filling funnel and insert the plunger into the funnel.
 8. Place the pulp container under the front cover and the juice jug under the juice outlet.
 9. The appliance is now ready for use.
 10. To disassemble, perform the procedure in reverse order.
2. Make sure that the lock is turned so that the arrow points to the open lock symbol.
 3. Insert the food grinder into the motor unit so that the protrusions on the grinder fit into the cut-outs in the fixing thread. Then turn the lock clockwise until the arrow points to the closed lock symbol and you feel resistance.
 4. Insert the worm shaft of the grinder into the grinding chamber. Rotate the worm shaft as necessary to engage the bearing in the motor unit.
 5. Fit the grinding blade onto the worm shaft. It is important that the blade is pointing out of the grinding chamber.



WARNING!
WHEN
ATTACHING THE
GRINDING BLADE,
BE VERY CAREFUL
NOT TO GET
INJURED WITH ITS
EDGE.

ASSEMBLING THE FOOD GRINDER

1. Place the motor unit on a dry, level and firm surface.
6. Attach one of the grinding discs on the grinding blade. Select a grinding disc depending on the preferred grinding roughness and intended meat use. Make sure that the protrusion in the grinding chamber is engaged with the notch in the grinding disc.
 7. Now attach the screw cap and screw it properly by turning clockwise. Make sure the cap is tightened securely. However, do not tighten with excessive force to avoid stripping the thread.

8. Fit the hopper onto the filling funnel and insert the plunger into the funnel.
9. The appliance is now ready for use.
10. To disassemble, perform the procedure in reverse order.

ASSEMBLING THE SAUSAGE PREPARATION GRINDER

1. Assemble the grinder according to steps 1–5 in **“Assembling the Food Grinder”**.
2. Put on the sausage maker attachment and the cap. Choose the size of the attachment depending on how thick you want your sausages to be.
3. Now attach the screw cap and screw it properly by turning clockwise. Make sure the cap is tightened securely. However, do not tighten with excessive force to avoid stripping the thread.
4. Fit the hopper onto the filling funnel and insert the plunger into the funnel.
5. The appliance is now ready for use.
6. To disassemble, perform the procedure in reverse order.

ASSEMBLING THE GRINDER FOR THE PREPARATION OF KUBBE

1. Assemble the grinder according to steps 1–3 in **“Assembling the Food Grinder”**.
2. Fit the kubbe preparation attachment onto the worm shaft. Make sure that the protrusion in the grinding chamber fits into the cut-out in the kubbe attachment. Then put on the cap.
3. Now attach the screw cap and screw it properly by turning clockwise. Make sure the cap is tightened securely. However, do not tighten with excessive force to avoid stripping the thread.
4. Fit the hopper onto the filling funnel and insert the plunger into the funnel.
5. The appliance is now ready for use.
6. To disassemble, perform the procedure in reverse order.

ASSEMBLING THE CUTTING AND GRATING ATTACHMENT

1. Place the motor unit on a dry, level and firm surface.
2. Make sure that the lock is turned so that the arrow points to the open lock symbol.
3. Insert the slicing and grating attachment into the motor unit so that the protrusions on the attachment fit into the cut-outs in the fixing thread. Then turn the lock clockwise until the arrow points to the closed lock symbol and you feel resistance.
4. Release the grater lock.
5. Insert one of the graters into the grinding chamber. Select a grater according to the ingredients processing method. Rotate the grater as necessary to engage the bearing in the motor unit.



WARNING!
WHEN
HANDLING THE
GRATERS, BE VERY
CAREFUL NOT TO
GET INJURED WITH
THEIR EDGE.

6. Secure the lock. Correct locking is indicated by a click.
7. Insert the plunger into the filling funnel.
8. The appliance is now ready for use.
9. To disassemble, perform the procedure in reverse order.

OPERATING YOUR FG 403 FOOD+

BEFORE FIRST USE



Before first use, remove all packaging and advertising labels / stickers from the appliance. Make sure you have removed all accessories from the package.

Wipe the motor unit with a soft cloth slightly dampened with warm water. Wipe dry using a clean wiping cloth.

Wash all parts of the juicing attachment, meat grinder and slicing and grating attachments in warm water with a little dishwashing liquid. Rinse in clean water and wipe dry.

Always make sure all parts are thoroughly dry before folding.

OPERATION

1. Assemble the appliance according to its intended use.
2. Place the assembled appliance on a dry, level and firm surface well away from the mains socket.
3. Place a container under the dispensing opening of the appliance.
4. Insert the mains cord plug into a power socket.
5. Press the  button to switch on the appliance.
6. Press the low or high speed button and the appliance will start.
7. Insert the ingredients one by one in the filling funnel using the plunger. Avoid choking the filling funnel with excessive amount of ingredients.
8. When all the ingredients are processed, press the  button to switch off the appliance. Then, unplug the power cord from the mains socket.
9. Remove the hopper from the filling funnel and put the bowl with the processed ingredients aside.
10. If the raw materials become clogged, turn off the appliance by pressing the  button and press the reverse button. Once the ingredients are released from the grinding chamber, continue processing.
11. Clean the appliance according to the instructions in the chapter "Care and Cleaning".



WARNING!
TO PUSH
INGREDIENTS
THROUGH THE
FILLING FUNNEL,
ALWAYS USE THE
SUPPLIED PLUNGER.
NEVER USE YOUR
FINGERS OR OTHER
ITEMS.

SPEED OVERVIEW TABLE

Low speed	Juicing soft fruits and vegetables (e.g. berries, tomatoes, etc.) Grinding of fine meat (e.g. fish) Grating and slicing of fruit and vegetables Preparation of kubbe and sausages
High speed	Juicing fruits and vegetables (e.g. apples, carrots, etc.) Grinding meat (beef, pork, game, etc.)

PREPARATION OF KUBBE

Kubbe (also kubbeh or kibbeh) is a group of dishes originating in the Middle East based on a mixture of spiced minced meat, onions and usually wheat semolina with various fillings. The ingredients are processed to form balls, which are then baked or fried.

PREPARATION OF SAUSAGES

Prepare the ingredients for the sausages and place them on the hopper. Soak the casings in lukewarm water for about 10 minutes and wait for them to soften. Then place the full length of the casings on the attachment. Make a knot at the end of the casing so that the sausage mixture does not spill out of the casing.

Select a low speed and while processing, hold the casing on the attachment with one hand and use the other hand to slowly push the ingredients through the filling funnel using pressure.

When the sausage is the desired length, stop the operation by pressing the ⏻ button.

Press the casing right at the attachment outlet with your fingers and rotate the sausage several times around its axis. Then switch the grinder on again and proceed in the same way until you have processed all the ingredients.

If the casing gets stuck on the attachment while being filled, wet it slightly with lukewarm water.

When filling, it is important that the mixture is loosely but evenly distributed in the sausage. If there is too much mixture in the sausage, it could burst during cooking or frying.

By choosing the grinding disc you choose the fineness or coarseness of the mixture in the sausage. If you prefer a coarser sausage mixture, use the grinding disc with the largest holes and vice versa.

CARE AND CLEANING

Before cleaning the appliance, always switch it off and unplug the power cord from the mains socket and allow it to cool down sufficiently. Disassemble the appliance and clean it according to the instructions below.



WARNING!
DO NOT WASH
THE APPLIANCE,
MAINS CORD AND
PLUG UNDER
RUNNING WATER
AND DO NOT
IMMERSE IT IN
WATER OR ANY
OTHER LIQUID.

CAUTION:
DO NOT USE SHARP OBJECTS,
CHEMICALS, THINNERS, PETROL
OR OTHER SIMILAR SUBSTANCES.
UNDER NO CIRCUMSTANCES
SHOULD THE APPLIANCE BE
CLEANED WITH A STEAM CLEANER.

MOTOR UNIT

Wipe the motor unit with a soft cloth slightly dampened with warm water. Wipe dry using a clean wiping cloth.

ACCESSORIES

Wash all parts of the juicing attachment, meat grinder and slicing and grating attachments in warm water with a little dishwashing liquid. Rinse in clean water and wipe dry. We recommend lubricating the grinding blade, grinding discs and worm shaft with a little vegetable oil.



WARNING!
BE CAREFUL
NOT TO INJURE
YOURSELF WHEN
HANDLING THE
GRINDING BLADE,
JUICING WORM
SHAFT, FINE
STRAINER OR
GRATERS.

STORAGE

Before storing, make sure that the appliance is clean, dry and completely cooled. Store it in a well-ventilated dry place out of reach of children and animals.

TROUBLESHOOTING

This chapter describes the most common problems you may encounter while using this appliance. If your problem is either not stated here or persists, stop using the appliance, unplug the power cord and contact your authorized service centre.

UNDER NO CONDITION SHOULD YOU REPAIR OR DISASSEMBLE THE APPLIANCE YOURSELVES. THE APPLIANCE CONTAINS NO USER SERVICEABLE PARTS.

Problem	Cause	Solution
The appliance will not start, the plug is plugged into the socket.	The plug is not plugged into the socket correctly.	Remove the plug from the socket and reconnect it. Plug the plug into another socket.
	The socket is not live.	Contact a qualified electrician.
There is a faint smell after the first switching on.	This is normal.	The unpleasant smell disappears after the first few uses. However, if it persists, contact an authorised service centre.
The appliance has switched itself off during use.	The voltage is too low.	Check the voltage at your power outlet.
	You have processed too much ingredients at one time.	Disconnect the appliance from the power supply. Disassemble and remove any stuck food.
	The appliance has been running for too long.	Overheating has occurred and the thermal fuse has activated. Disconnect the appliance from the power supply and allow it to cool down.
An unusual sound comes from the appliance during use.	The appliance is not assembled correctly.	Switch off the appliance and disconnect it from the power supply. Disassemble, inspect and reassemble the appliance.
	The motor unit is damaged.	Stop using the appliance and contact an authorised service centre.

INSTRUCTIONS AND INFORMATION ON DISPOSING OF USED PACKAGING MATERIALS

Dispose of used packaging material at a site designated for waste in your municipality.

DISPOSING OF USED ELECTRICAL AND ELECTRONIC EQUIPMENT



This symbol on products or original documents means that used electric or electronic products must not be added to ordinary municipal waste. For proper disposal and recycling, take these products to designated collection points. Or in some European Union states or other European countries the products can be returned to the local retailer when buying an equivalent new product. Disposing of this product correctly helps save valuable natural resources and prevents damage to the environment by improper waste disposal. Ask your local authorities or collection facility for more details. In accordance with national regulations penalties may be imposed for the incorrect disposal of this type of waste.

For business entities in European Union states

If you want to dispose of electric or electronic devices, ask your retailer or supplier for the necessary information.

Disposal in other countries outside the European Union

This symbol is valid in the European Union. If you wish to dispose of this product, request the necessary information about the correct disposal method from the local council or from your retailer.



This product meets all the basic requirements of the applicable EU directives.

The text, design and technical specifications may be changed without prior notice and we reserve the right to make these changes.

The original version is in the Czech language.

Manufacturer's address: FAST ČR, a.s., U Sanitasu 1621, Říčany CZ-251 01

NOTES

Because of continuous improvement of design and other properties, your product may slightly differ from the one shown on the pictures in this manual.

Z dôvodu neustáleho zdokonaľovania dizajnu a ďalších vlastností sa môže vámi zakúpený výrobek mírně lišiť od výrobku uvedeného na obrázcích v tomto návode.

Z dôvodu neustáleho zdokonaľovania dizajnu a ďalších vlastností sa môže vámi kúpený výrobok mierne lišiť od výrobku uvedeného na obrázkoch v tomto návode.

A kivitel és más jellemzők állandó fejlesztése miatt a megvásárolt termék enyhén eltérhet az ezen útmutatóban található képeken mutatott terméktől.

Ze względu na ciągłe udoskonalanie designu i innych właściwości, zakupiony produkt może się nieznacznie różnić od produktu przedstawionego na rysunkach w niniejszej instrukcji.

**WWW.CATLER.EU**